

Ex-key-operated switch for panel mounting



Key-operated switch

4 Technical data

Key-operated switch Type 418 8195

	Complete certificate ¹⁾	Component certificate
Marking accd. to 2014/34/EU	⊕ II 2 G Ex de IIC T6	⊕ II 2 G Ex de IIC/IIB Gb ⊕ I M2 Ex de I Mb
EC-Type Examination Certificate	PTB 99 ATEX 1034	IBExU 14 ATEX 1030 U
IECEX Certificate of Conformity		IECEX IBE 14.0005 U
Marking accd. to IECEx		Ex de IIC/IIB Gb Ex de I Mb
Operating temperature range	-55 °C up to +80 °C	-45 °C up to +80 °C (IIC) -60 °C up to +80 °C (IIB)
Permissible ambient temperature	-25 °C up to +50 °C	
Application temperature ²⁾		-45 °C up to +55 °C (IIC) -60 °C up to +55 °C (IIB)
Rated voltage	400 V AC	500 V AC
Rated current	16 A	16 A
Rated current with gold contact points	0.4 A	0.4 A
Rated making-/rated breaking capacity accd. EN 60947-5-1	AC-15: U _e 250 V / I _e 6 A U _e 400 V / I _e 4 A DC-13: U _e 24 V / I _e 6 A U _e 220 V / I _e 1 A	AC-15: U _e 250 V / I _e 6 A U _e 500 V / I _e 4 A DC-13: U _e 24 V / I _e 6 A U _e 220 V / I _e 1 A
Connecting terminals	2 x 2.5 mm ²	2 x 2.5 mm ²
Degree of protection accd. to EN 60529	IP66 ¹⁾	IP00
Dimensions (L x W x H)	approx. 188 x 38 x 67 mm	approx. 139 x 38 x 57 mm
Weight	0.30kg	0.25 kg
Cable gland	M25x1.5 Ø 6 - 15 mm	--
Type of mounting	Ø 30.3 mm fixing hole	Ø 30.3 mm fixing hole
Enclosure colour	grey	grey
Gasket material	Neoprene (standard), Fluoric Silicone or Viton on request	

¹⁾ with protective cover IP66

²⁾ The limits of the operating temperature range and the max. permissible temperature rise of the components have to be taken into account. See also pages 2.4.34/35.



Key-operated switch

Ordering code for components A - B - C1 - (C2)

Code A B C
 Order No. GHG 418 8195 R5 _ _

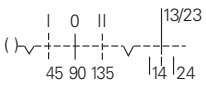
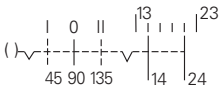
Code	Component	Code	
A	Key-operated switch	GHG 418 8195	
Code	Circuit	Contacts	Code silver contact points gold contact points
B	2 NC		4 7
	2 NO		5 8
Code	Inscription	Code	
C	I - 0 - II	07	
	Fern - 0 - Ort	08	
	Hand - 0 - Auto	09	

Example for order No.

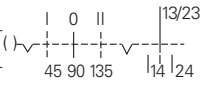
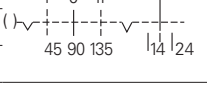
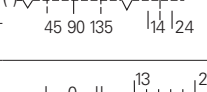
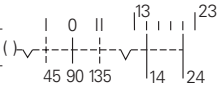
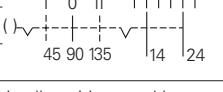
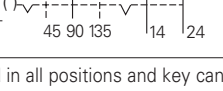
Switching mechanism	Contact-system	Label	Order No.		
			A	C	D
Key-operated switch, without protective cover					
4		I 0 II	GHG 418 8195	R 5 4	07
4		FERN 0 ORT	GHG 418 8195	R 5 4	08
4		HAND 0 AUTO	GHG 418 8195	R 5 4	09
5		I 0 II	GHG 418 8195	R 5 5	07
5		FERN 0 ORT	GHG 418 8195	R 5 5	08
5		HAND 0 AUTO	GHG 418 8195	R 5 5	09

Switch can be locked in all positions and key can be removed in all positions

Key-operated switch with gold contact points, without protective cover

4		I 0 II	GHG 418 8195	R 5 7	07
4		FERN 0 ORT	GHG 418 8195	R 5 7	08
4		HAND 0 AUTO	GHG 418 8195	R 5 7	09
5		I 0 II	GHG 418 8195	R 5 8	07
5		FERN 0 ORT	GHG 418 8195	R 5 8	08
5		HAND 0 AUTO	GHG 418 8195	R 5 8	09

Accessories

Type	OU	Order No.
Protective cover to meet IP66	5	GHG 410 1939 R0002

Please pay attention that only order units (OU) according to the ordering details can be delivered.

Ex-key-operated switch for panel mounting



Key-operated switch

4 Dimension drawing

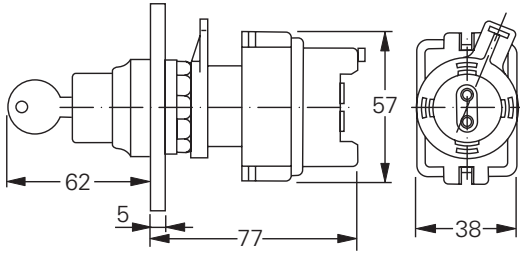

Key-operated switch without protective cover

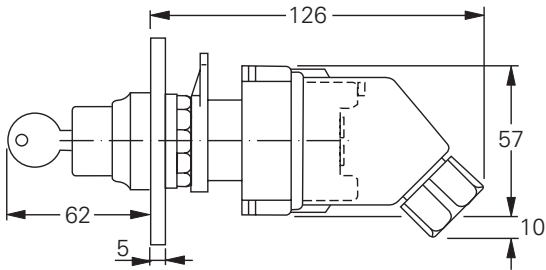

Key-operated switch with protective cover

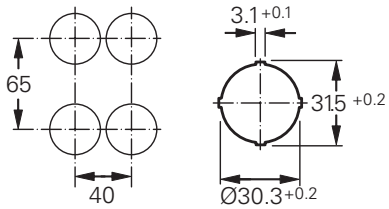

Minimum distances